

LIFT POINT. REMOVE SET SCREW AND INSTALL 1/2-13 X 1" HOIST RING OR LIFT EYE FOR JACK INSTALLATION OR REMOVAL.

STANDARD 1/2" SQUARE SOCKET DRIVE

4X Ø.672 THRU PLATE FOR 5/8 BOLTS. GR8 OR STRONGER FASTENERS AND HIGH STRENGTH WASHERS RECOMMENDED

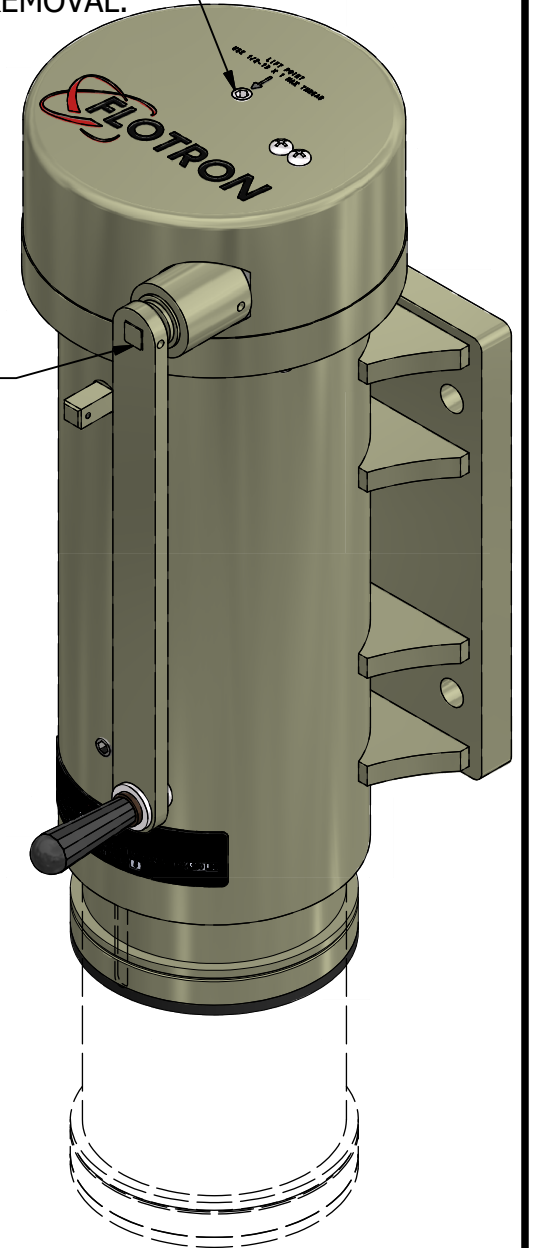

SWIVEL FOOT WITH RUBBER PAD ON FOOT TO PROTECT AND ACCOMMODATE UNEVEN FLOORS (UP TO 1.75° FLOOR DEVIATION PER JACK)

- 8. CONFIGURATION SHOWN ON THIS SHEET: LJ-8500-F1-J2
- 7. SEE SHEET 2 FOR CASTER JACK (CJ) OPTION
- 6. IN LIEU OF USING THE PROVIDED HAND CRANK, A HAND DRILL CAN BE USED TO ROTATE THE INPUT CLUTCH/SHAFT. SINCE THIS JACK HAS A CLUTCH, THE USER DOES NOT NEED TO WORRY ABOUT DAMAGING JACK FROM OVER TORQUING.
- 5. JACK HANDLE ORIENTATION CAN BE ROTATED +/-90° IN 45° INCREMENTS FROM WHAT IS SHOWN ON THIS VIEW. TO DO THIS, FIRST REMOVE THE TWO FILL/DRAIN PLUGS ON THE TOP OF THE JACK. NEXT, TIP THE JACK UPSIDE DOWN AND DRAIN ALL OIL FROM THE TOP CAP. ONCE THE OIL HAS BEEN DRAINED, REMOVE THE 8 MOUNTING FASTENERS FROM TOP CAP AND ROTATE THE CAP TO THE DESIRED ORIENTATION. FINALLY, RE-INSTALL THE TOP CAP MOUNTING FASTENERS AND RE-FILL THE JACK WITH 9 OZ OF MOBIL SHC 634 OIL USING A FUNNEL. RE-INSTALL THE TWO FILL/DRAIN PLUGS. "J2" HANDLE ORIENTATION SHOWN.
- 4. 50 TURNS OF HANDLE PER INCH LIFT OF JACK.
- 3. FINISHES: CLASS 1K (ISO 6)/CLEAN ROOM COMPATIBLE AND NO ZINC.
- 2. LUBRICANTS: SYNCO SUPER LUBE GREASE STANDARD ON SCREW THREADS.
KRYTOX LVP LUBRICANT ON SCREW WITH (L1) LUBRICANT OPTION.
BRAYCOTE LUBRICANT ON SCREW WITH (L2) LUBRICANT OPTION.
- 1. JACK CAPACITY: SIMULTANEOUS 8,500 LBS [3,855 KG] VERTICAL LOAD & 4,250 LB [1,928 KG] SIDE LOAD WITH SF_y=3 & SF_u=5.

NOTES:

PROPRIETARY
This Drawing is the property of FLOTRON, Inc. and is not to be used, copied or reproduced in any way other than for the particular purpose for which it is provided, and when said purpose has been fulfilled, it should be destroyed or returned to FLOTRON, Inc.

TOLERANCES UNLESS OTHERWISE SPECIFIED		FLOTRON [®]		2630 PROGRESS STREET VISTA, CALIFORNIA 92081 http://www.flotron.com					
FRACTION	DEC.					ANGLES			
±.03	±.010	±5°	JACK, LEVELING & CASTER, 8,500/6,000 LB CAPACITY						
.XX	.XXX								
APPROVALS	DATE	SCALE				SIZE	DRAWING NO.	REV	
DRAWN	AJZ	1/18/2019				1 : 4	B	8026-200PROP	-
CHECKED									
MFG									
STATUS	Released	WT: 123.6 lbmass	Cad software: Inventor	SHEET 1 OF 2					

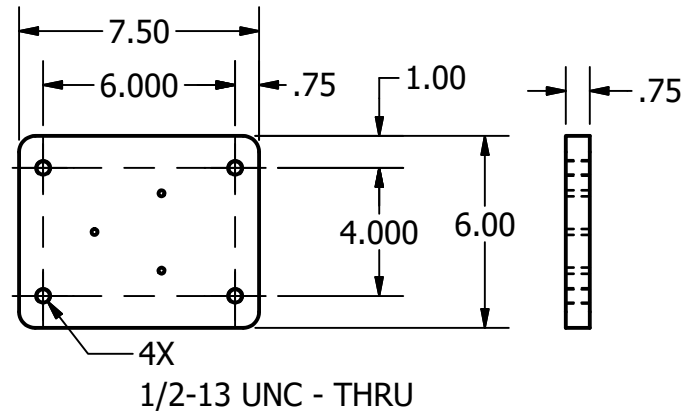

CASTER MOUNTING PLATE DETAIL

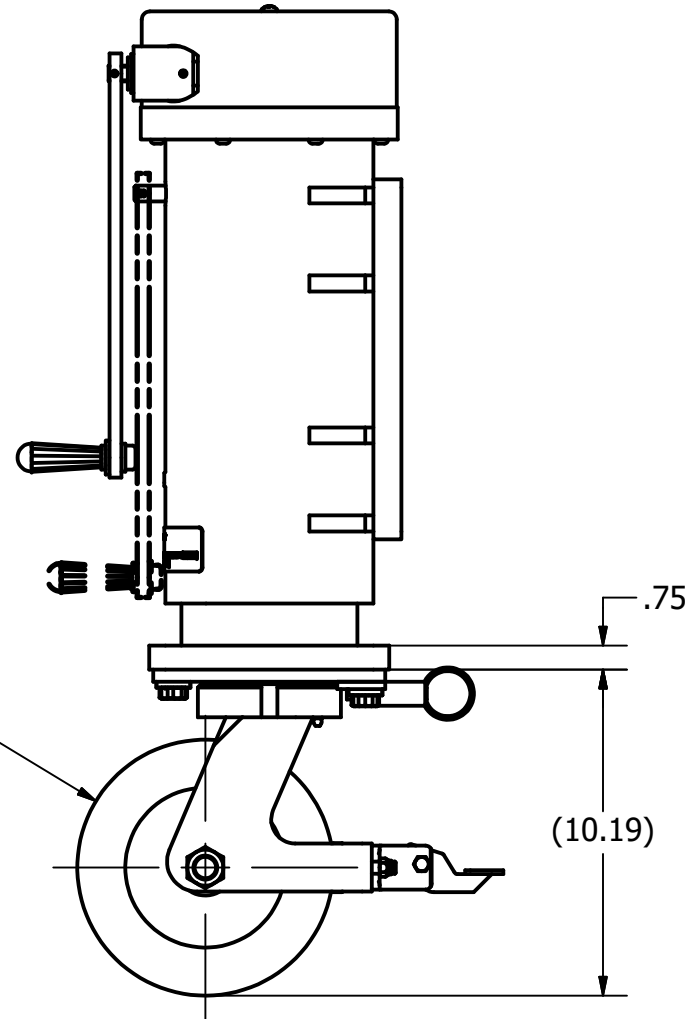
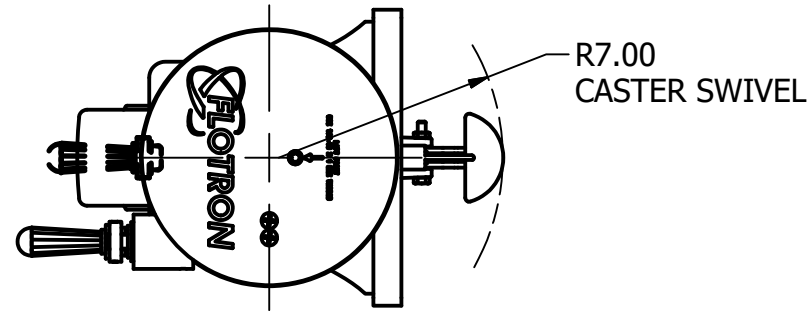

Ø8.00 NYLON WHEEL
CASTER WITH 4 POSITION
SWIVEL LOCK AND BRAKE

5.94 (RETRACTED)
TO
13.75 (EXTENDED)

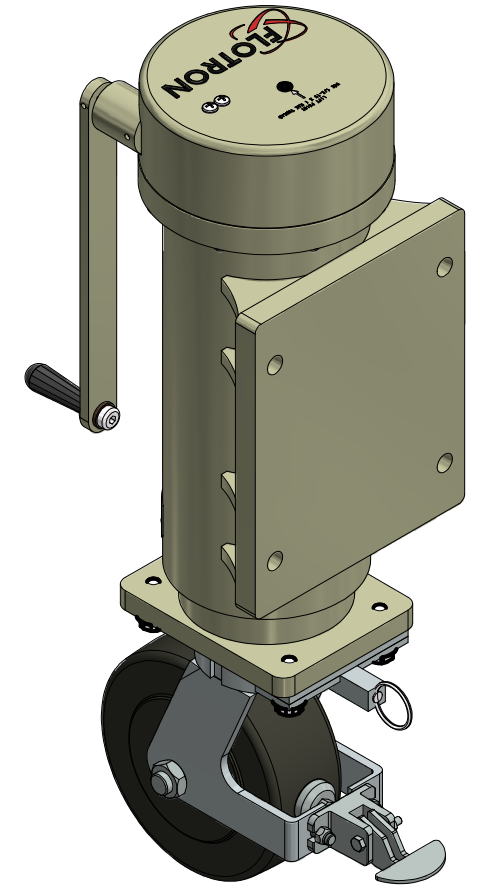
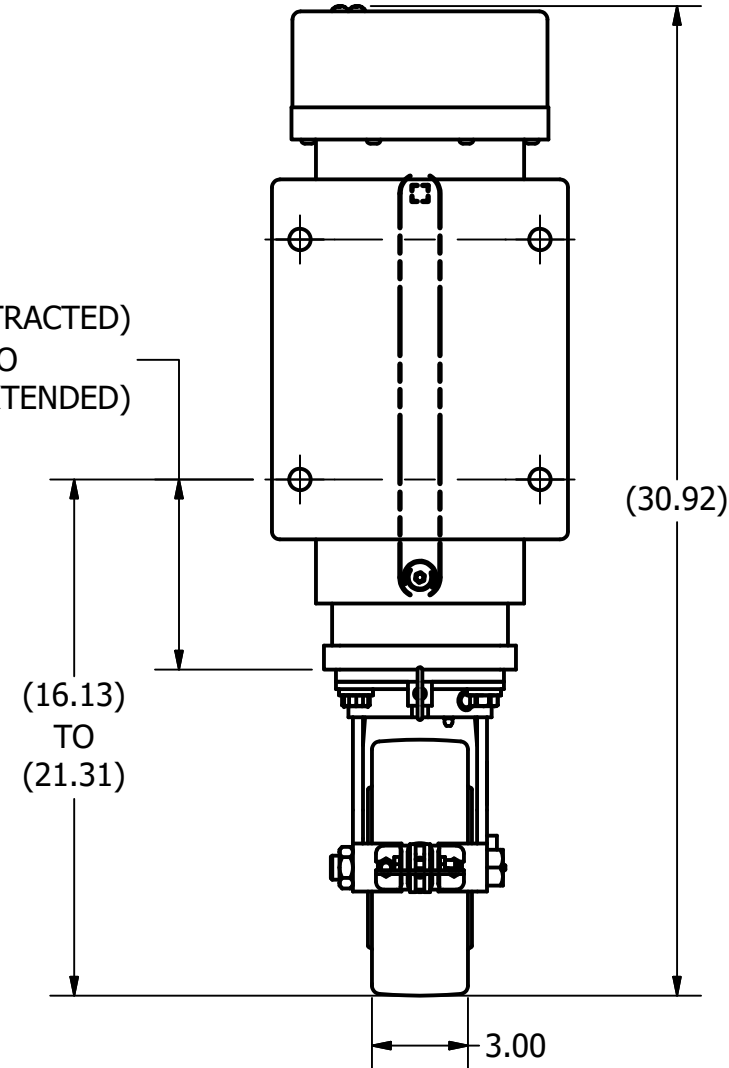

5. CONFIGURATION SHOWN ON THIS SHEET: CJ-6000-C2-J2
4. TO ORDER CASTER JACK WITH CASTER MOUNTING PLATE ONLY (NO CASTER & MOUNTING HARDWARE) SPECIFY C1 OPTION IN CONFIGURATION.
3. CASTER HAS ZINC PLATED STEEL FASTENERS AND COMPONENTS AS STANDARD. FOR NO ZINC AND AN ALL STAINLESS AND POWDER COATED CASTER, SPECIFY "C" FINISH IN CONFIGURATION.
2. CASTER LUBRICANTS: GENERAL PURPOSE BEARING GREASE STANDARD IN CASTER SWIVEL BEARING. KRYTOX LVP LUBRICANT ON SCREW AND IN CASTER SWIVEL BEARING WITH (L1) LUBRICANT OPTION. BRAYCOTE LUBRICANT ON SCREW AND IN CASTER SWIVEL BEARING WITH (L2) LUBRICANT OPTION.
1. CASTER JACK CAPACITY: SIMULTANEOUS 6,000 LBS [2,701 KG] VERTICAL LOAD & 3,000 LB [1,361 KG] SIDE LOAD ON CASTER WHEEL WITH SFy=3 & SFu=5.

NOTES:

This Drawing is the property of FLOTRON, Inc. and is not to be used, copied or reproduced in any way other than for the particular purpose for which it is provided, and when said purpose has been fulfilled, it should be destroyed or returned to FLOTRON, Inc.

		2630 PROGRESS STREET VISTA, CALIFORNIA 92081 http://www.flotron.com	
		SCALE	SIZE
1 : 4	B	8026-200PROP	-
SHEET			2 OF 2